



**BAY COUNTY DRAIN COMMISSIONER**

**Michael Rivard**

515 Center Avenue, Suite 601  
Bay City, MI 48708

**ROUCHE DRAIN**

**NOTICE OF DAY OF REVIEW OF DRAINAGE DISTRICT BOUNDARIES  
AND REVIEW OF APPORTIONMENTS**

**DATE:** Wednesday, June 25, 2025  
**TIME:** 9:00 a.m. to 5:00 p.m.  
**LOCATION:** Bay County Drain Commissioner's Office  
515 Center Avenue, Suite 601  
Bay City, MI 48708  
**QUESTIONS:** (989) 895-4290

The Bay County Drain Commissioner will hold a Day of Review of Drainage District Boundaries and Apportionments on the above date, time, and location. The Day of Review is an opportunity to review the Rouche Drain Drainage District boundaries and the tentative apportionment of benefits for each parcel and municipality within the Drainage District with the Drain Commissioner or staff member. A map of the proposed Drainage District boundary revisions can be found on the Drain Commissioner's website at: <https://www.baycountymi.gov/DrainCommissioner/Meeting-Notices.aspx>.

The following is a list of any county, township, city, or village to be assessed: Bay County and Portsmouth Township.

**At the Day of Review:**

- No appointment is necessary.
- The Drain Commissioner, engineers and/or other staff members will be available to assist individuals and make revisions where necessary.
- The computation of costs for the Drain will be available.

Persons with disabilities needing accommodations for effective participation in the Day of Review should contact the Drain Commissioner's Office at the number noted above (voice) or through the Michigan Relay Center at 7-1-1 (TDD) at least 24 hours in advance of the Day of Review to request mobility, visual, hearing, or other assistance.

**Comments**

Comments on the apportionment of benefits may be submitted in writing or verbally at the Day of Review. Comments may also be submitted in writing before the date of the Day of Review to:

**MAIL:** Bay County Drain Commissioner  
515 Center Avenue, Suite 601  
Bay City, MI 48708  
**EMAIL:** [drainoffice@baycountymi.gov](mailto:drainoffice@baycountymi.gov)

Comments submitted in advance must be received by the Drain Commissioner prior to the Day of Review to ensure consideration.

**Assessments & Appeals**

Drain assessments are collected in the same manner as property taxes and will appear on your winter tax bill. If drain assessments are being collected for more than one (1) year, you may pay the assessment in full with any interest to date at any time and avoid further interest charges.

You may appeal the Drain Commissioner's decision to revise the district boundary to the Bay County Circuit Court within ten (10) days. You may appeal the Drain Commissioner's determination of apportionments to the Bay County Probate Court within ten (10) days.

Michael Rivard  
Bay County Drain Commissioner

# ROUCHE DRAIN DRAINAGE DISTRICT

## BAY COUNTY DRAIN COMMISSIONER

### MICHAEL RIVARD

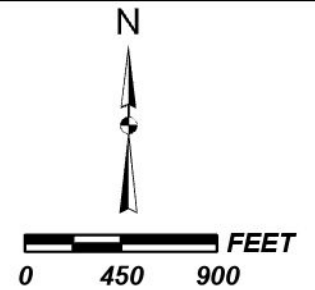
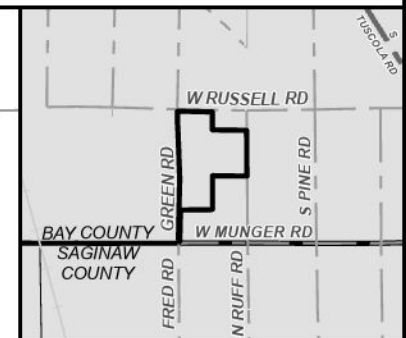
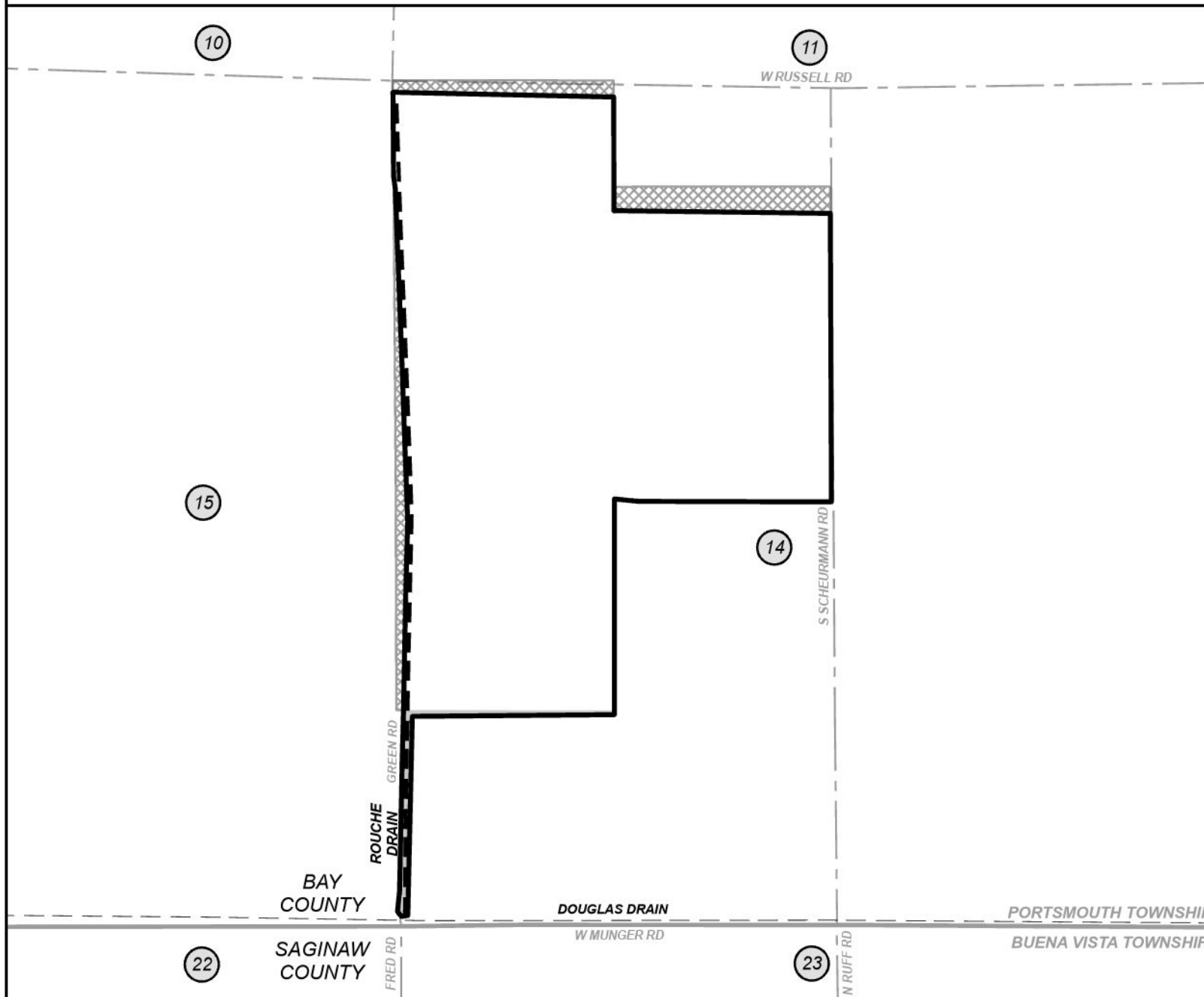

#### LEGEND

- DRAINAGE DISTRICT BOUNDARY
- DRAIN
- OUTLET WATERCOURSE
- LANDS ADDED
- LANDS REMOVED
- MUNICIPALITY BOUNDARIES
- STATE ROADS
- COUNTY ROADS
- LOCAL ROADS
- RAILROAD